

INSTALLATION INSTRUCTIONS

69-7083TS
INFINITI
2014 Q50
V6-3.7L

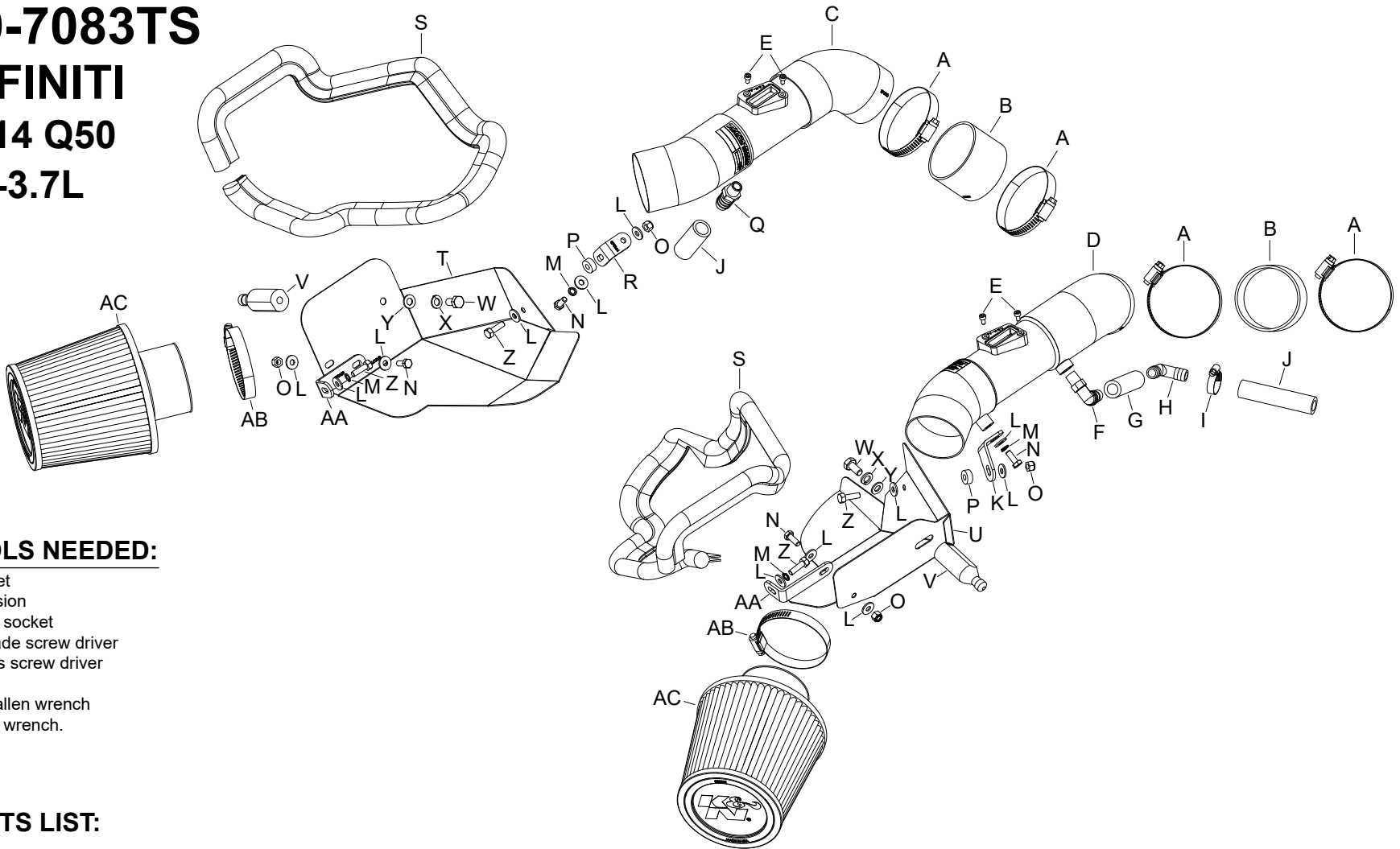

TOOLS NEEDED:

- Ratchet
- Extension
- 13mm socket
- flat blade screw driver
- Phillips screw driver
- Pliers
- 3mm allen wrench
- 10mm wrench.

PARTS LIST:

Description	Qty.	Part #	Description	Qty.	Part #	Description	Qty.	Part #
A HOSE CLAMP; #44 STAINLESS	4	08560	K BRACKET; ANGLED SMALL	1	070049	U HEAT SHIELD	1	073172
B HOSE; 2.75"ID X 2"L	2	08440	L WASHER; 6MM FLAT	12	08269	V STANDOFF; AIRBOX	2	06532
C INTAKE TUBE; (PASSENGER)	1	27620TS	M WASHER; 6M SPLIT LOCK	4	1-3025	W BOLT; 8MM-1.25 X 16MM	2	07844
D INTAKE TUBE; (DRIVER)	1	27621TS	N BOLT; M6-1 X 16MM	4	07812	X WASHER; M8 SPLIT LOCK	2	1-3036
E BOLT; M4-.7 X 8MM	4	07733	O NUT; 6MM NYLOCK	4	07512	Y WASHER; 8MM FLAT	2	08272
F VENT; 90 DEG, 1/2" HOSE	1	08110FK	P SPACER; .625"OD X .250"ID	2	06555	Z BOLT; M6 X 1 X 20MM	4	07795
G HOSE; 1/2"ID X 3.5"L	1	087028	Q FITTING; VENT, 1/4"NPT	1	82638	AA BRACKET; "L"	2	070109
H FITTING; VENT 1/2 X 1/2	1	08065	R BRACKET; "L" SML.	1	070066A	AB HOSE CLAMP; #44	2	08577
I HOSE CLAMP; #8 MINI	1	08410	S EDGE TRIM; 39"L	2	102496	AC AIR FILTER	2	RU-4960XD
J HOSE; 5/8"ID X 7.5"L	1	084008	T HEAT SHIELD	1	073171			

If you need any assistance please call 1-800-858-3333 to speak with a representative in our Customer Service Center before returning the product.

NOTE: FAILURE TO FOLLOW INSTALLATION INSTRUCTIONS AND NOT USING THE PROVIDED HARDWARE MAY DAMAGE THE INTAKE TUBE, THROTTLE BODY AND ENGINE.

TO START:

1. Turn off the ignition and disconnect the negative battery cable.
NOTE: Disconnecting the negative battery cable erases pre-programmed electronic memories. Write down all memory settings before disconnecting the negative battery cable. Some radios will require an anti-theft code to be entered after the battery is reconnected. The anti-theft code is typically supplied with your owner's manual. In the event your vehicles anti-theft code cannot be recovered, contact an authorized dealership to obtain your vehicles anti-theft code.



2. Remove the three bolts and two nuts securing the decorative engine cover and then remove the engine cover.



3. Release the eight clips securing the core support decorative cover and then remove the cover from the vehicle.



4. Disconnect the Passenger side mass air sensor electrical connection and unhook the wiring harness from the air box.



5. Remove the two bolts that secure passenger side air box and loosen the hose clamp to the intake tube.
NOTE: The outer bolt is under a decorative cover, the cover will flex up enough to gain access to the bolt.



6. Lift up and remove the passenger side air box from the vehicle.

NOTE: K&N Engineering, Inc., recommends that customers do not discard factory air intake.



7. Loosen the hose clamp securing the passenger side intake hose to the throttle body and remove the bolt securing the crank case vent to the intake manifold.



8. Pull the intake hose up to gain access to the crank case vent to valve cover connection. Release the clamp securing the crank case vent and then remove the passenger intake hose assembly.



9. Disconnect the driver side mass air sensor electrical connection and unhook the wiring harness from the air box.



10. Remove the two bolts that secure driver side air box and loosen the hose clamp to the intake tube. **NOTE: The outer bolt is under a decorative cover, the cover will flex up enough to gain access to the bolt.**



11. Remove the driver's side air box from the vehicle.



12. Loosen the hose clamp securing the driver's side intake hose to the throttle body.



13. Pull the intake hose up to gain access to the crank case vent to valve cover connection. Release the clamp securing the crank case vent and then remove the driver's intake hose assembly.



14. Install the provided coupling hose (08440) onto the passenger side throttle body and secure with the provided hose clamp.



15. Install the mounting bracket (070109) onto the passenger side heat shield (073171) as shown and secure with the provided hardware.



16. Install the provided mounting stud onto the passenger side heat shield and secure with the provided hardware.



17. Install one of the provided edge trim pieces onto the passenger side heat shield as shown. **NOTE: It will be necessary to trim the edge trim for proper fit.**



18. Install the heat shield into position as shown on the passenger side frame rail and then secure to the core support with the provided hardware. **NOTE: The mounting stud will insert into the factory air box mounting grommet.**



19. Install the provided straight vent fitting into the passenger side K&N® intake tube (27620) as shown.



20. Remove the two screws securing the passenger side mass air sensor into the air box and then remove the sensor.



21. Install the mass air sensor into the K&N® intake tube and secure with the provided hardware.

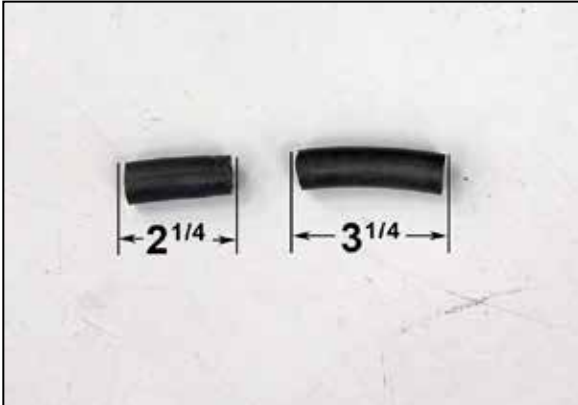

22. Cut the provided crank case vent hose into two sections as shown. One section is to be 2-1/4" long; the other section is to be 3-1/4" long.



23. Install the 3-1/4" long section onto the fitting installed into the passenger side K&N® intake tube as shown.



24. Install the tube mounting bracket (070066) onto the passenger side K&N® intake tube as shown but do not completely tighten at this time.



25. Install the Passenger side K&N® intake tube assembly into the coupling hose at the throttle body and the crank case vent hose onto the valve cover port. Align the mounting bracket with the hole in the heat shield and secure with the provided hardware. Do not completely tighten the mounting points at this time.

NOTE: The crank case vent hose may be hard to install especially in colder temperatures, it may be helpful to use a lubricant or to submerge the hose in warm water to ease installation. . Be sure to install the provided spacer between the tube mounting bracket and the heat shield.



26. Install the K&N® air filter and secure with the provided hose clamp. Adjust the intake tube, heat shield and filter for pest fit and then secure all of the mounting points.

NOTE: Drycharger® air filter wrap; part # RX-4990DK is available to purchase separately. To learn more about Drycharger® filter wraps or look up color availability please visit <http://www.knfilters.com>®.



27. Reconnect the mass air sensor electrical connection.



28. Install the remaining coupling hose (08440) onto the driver's side throttle body and secure with the provided hose clamp.



29. Install the heat shield mounting bracket (070109) onto the driver's side heat shield (073172) and secure with the provided hardware.



30. Install the provided mounting stud onto the driver's side heat shield and secure with the provided hardware.



31. Install one of the provided edge trim pieces onto the driver's side heat shield as shown. **NOTE: It will be necessary to trim the edge trim for proper fit.**



32. Install the heat shield into position as shown on the driver side frame rail and then secure to the core support with the provided hardware.

NOTE: The mounting stud will insert into the factory air box mounting grommet.



33. Install the provided 90° vent fitting into the passenger side K&N® intake tube (27620) as shown. **NOTE: NPT fitting has tapered threads and only designed to be installed until hand tight, then tighten one rotation or when the fitting becomes difficult to return.**



34. Remove the two screws securing the driver's side mass air sensor into the air box and then remove the sensor.



35. Install the mass air sensor into the K&N® intake tube and secure with the provided hardware.



36. Install the 5/8" and 1/2" crank case vent hose's onto the 1/2" 90° fitting.

NOTE: Secure the 5/8" hose with the provided clamp.



37. Install the vent assembly onto the vent fitting installed into the K&N® intake tube.



38. Install the tube mounting bracket (070049) onto the K&N® intake tube and secure with the provided hardware.

NOTE: Do not completely tighten the bracket at this time.



39. Install the driver side K&N® intake tube assembly into the coupling hose at the throttle body and the crank case vent hose onto the valve cover port. Align the mounting bracket with the hole in the heat shield and secure with the provided hardware. Do not completely tighten the mounting points at this time.

NOTE: The crank case vent hose may be hard to install especially in colder temperatures, it may be helpful to use a lubricant or to submerge the hose in warm water to ease installation. Be sure to install the provided spacer between the tube mounting bracket and the heat shield.



40. Install the K&N® air filter and secure with the provided hose clamp. Adjust the intake tube, heat shield and filter for pest fit and then secure all of the mounting points.



41. Reconnect the mass air sensor electrical connection.



42. Reinstall the Decorative cover and secure with the eight clips.



43. Reinstall the decorative engine cover and secure with the factory hardware.



44. Reconnect the vehicle's negative battery cable. Double check to make sure everything is tight and properly positioned before starting the vehicle.

45. It will be necessary for all K&N® high flow intake systems to be checked periodically for realignment, clearance and tightening of all connections. Failure to follow the above instructions or proper maintenance may void warranty.

ROAD TESTING:

1. Start the engine with the transmission in neutral or park, and the parking brake engaged. Listen for air leaks or odd noises. For air leaks secure hoses and connections. For odd noises, find cause and repair before proceeding. This kit will function identically to the factory system except for being louder and much more responsive.

2. Test drive the vehicle. Listen for odd noises or rattles and fix as necessary.

3. If road test is fine, you can now enjoy the added power and performance from your kit.

4. K&N Engineering, Inc., requires cleaning the intake system's air filter element every 100,000 miles. When used in dusty or off-road environments, our filters will require cleaning more often. We recommend that you visually inspect your filter once every 25,000 miles to determine if the screen is still visible. When the screen is no longer visible some place on the filter element, it is time to clean it. To clean and re-oil, purchase our filter Recharger® service kit, part number 99-5050 or 99-5000 and follow the easy instructions.

NOT LEGAL FOR SALE OR USE ON ANY POLLUTION CONTROLLED MOTOR VEHICLE IN CALIFORNIA OR STATES ADOPTING CALIFORNIA EMISSION PROCEDURES.

See knfilters.com for CARB status on each part for a specific vehicle